

# 107 NU-L60



Sello mecánico de fuelle, no equilibrado, muelle simple, sentido de rotación independiente.  
Garniture mécanique à soufflet, non équilibrée, ressort simple, sens de rotation indépendant.  
Bellows mechanical seal, unbalanced, single spring, independent on direction of rotation.  
Rollbalgdichtung, nicht entlastet, einfache Feder, drehrichtungsunabhängig.

TABLA DIMENSIONAL (Dimensiones en mm. sujetas a variaciones o modificaciones)

TABLEAU DIMENSIONNEL (Dimensions en mm. sujettes à variations ou modifications)

Ref.	d <sub>1</sub>	d <sub>3</sub>	d <sub>4</sub>	d <sub>6</sub>	d <sub>7</sub>	l <sub>1N</sub>	l <sub>3</sub>	l <sub>4</sub>	l <sub>5</sub>	l <sub>6</sub>
10	10	22.5	25.0	17.0	21.0	40.0	33.4	6.6	1.5	4
12	12	25.0	27.5	19.0	23.0	40.0	33.4	6.6	1.5	4
14	14	28.5	32.0	21.0	25.0	40.0	33.4	6.6	1.5	4
16	16	28.5	32.0	23.0	27.0	40.0	33.4	6.6	1.5	4
18	18	32.0	34.5	27.0	33.0	45.0	37.5	7.5	2.0	4
20	20	37.0	39.5	29.0	35.0	45.0	37.5	7.5	2.0	5
22	22	37.0	39.5	31.0	37.0	45.0	37.5	7.5	2.0	5
24	24	42.5	45.0	33.0	39.0	50.0	42.5	7.5	2.0	5
25	25	42.5	45.0	34.0	40.0	50.0	42.5	7.5	2.0	5
28	28	49.0	51.5	37.0	43.0	50.0	42.5	7.5	2.0	5
30	30	49.0	51.5	39.0	45.0	50.0	42.5	7.5	2.0	5
32	32	53.5	56.0	42.0	48.0	55.0	47.5	7.5	2.0	5
33	33	53.5	56.0	42.0	48.0	55.0	47.5	7.5	2.0	5
35	35	57.0	59.5	44.0	50.0	55.0	47.5	7.5	2.0	5
38	38	59.0	61.5	49.0	56.0	55.0	46.0	9.0	2.0	6
40	40	62.0	64.5	51.0	58.0	55.0	46.0	9.0	2.0	6
43	43	65.5	68.0	54.0	61.0	60.0	51.0	9.0	2.0	6
45	45	68.0	70.5	56.0	63.0	60.0	51.0	9.0	2.0	6
48	48	70.5	73.0	59.0	66.0	60.0	51.0	9.0	2.0	6
50	50	74.0	74.5	62.0	70.0	60.0	50.5	9.5	2.5	6
53	53	78.5	82.5	65.0	73.0	70.0	59.0	11.0	2.5	6
55	55	81.0	85.0	67.0	75.0	70.0	59.0	11.0	2.5	6
58	58	85.5	89.5	70.0	78.0	70.0	59.0	11.0	2.5	6
60	60	88.5	92.5	72.0	80.0	70.0	59.0	11.0	2.5	6
65	65	93.5	97.5	77.0	85.0	80.0	69.0	11.0	2.5	6
68	68	96.5	100.5	81.0	90.0	80.0	68.7	11.3	2.5	7
70	70	99.5	103.5	83.0	92.0	80.0	68.7	11.3	2.5	7
75	75	107.0	111.0	88.0	97.0	80.0	68.7	11.3	2.5	7
80	80	112.0	116.0	95.0	105.0	90.0	78.0	12.0	3.0	7
85	85	120.0	124.0	100.0	110.0	90.0	76.0	14.0	3.0	7
90	90	127.0	131.0	105.0	115.0	90.0	76.0	14.0	3.0	7
95	95	132.0	136.0	110.0	120.0	90.0	76.0	14.0	3.0	7
100	100	137.0	141.0	115.0	125.0	90.0	76.0	14.0	3.0	7

DIMENSIONS TABLE (Measures in mm. subject to change)

TABELLE DER ABMESSUNGEN (In mm. Abweichungen oder Änderungen vorbehalten)

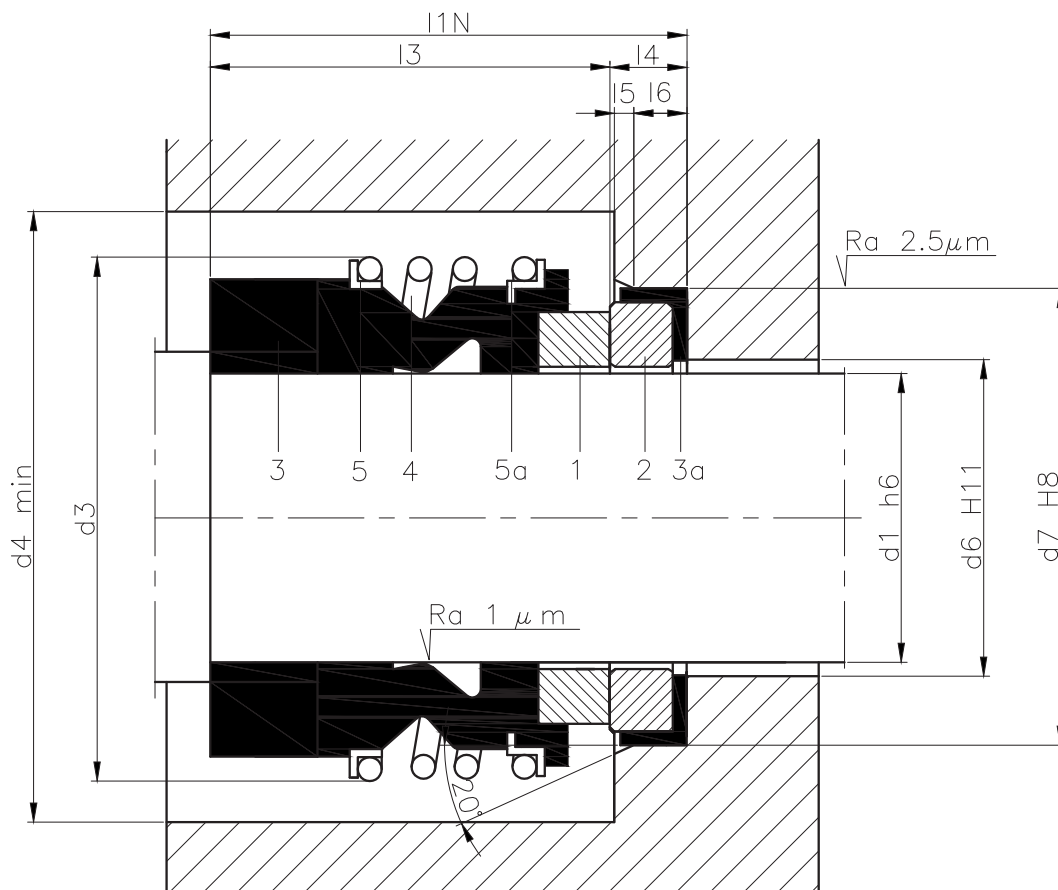

Tolerancia  $I_{N}$  / Tolérance  $I_{N}$  / Tolerances  $I_{N}$  / Toleranz  $I_{N}$  d, 10... 12 mm  $\pm$  0.5; 14... 18 mm  $\pm$  1.0; 20... 25 mm  $\pm$  1.5; 28... 100 mm  $\pm$  2.0

**LÍMITES OPERATIVOS / LIMITES D'UTILISATION / OPERATING LIMITS / EINSATZGRENZEN**

$d_1$  = 10 ÷ 100 mm

$p/d$  = 12 Kg/cm<sup>2</sup>

$v/g$  = 10 m/s

$t$  = -15 ÷ +200°C

Los límites operativos vienen condicionados por el factor PV

Les limites d'utilisation ci-dessus peuvent varier en fonction du facteur PV

The operating limits depend on the PV factor

Die Einsatzgrenzen werden durch den DG-Faktor festgelegt

**MATERIALES / MATÉRIAUX / MATERIALS / MATERIALIEN**

BOEFF  
BQPFF  
BQVFF

BVEFF  
BVPFF  
BVVFF

QOEFF  
QQPFF  
QQVFF

**COMPONENTES / CONSTRUCTION / COMPONENTS / KOMPONENTEN**

1 Cara de roce rotante / Grain mobile / Rotative face / Rotierende Gleitfläche

2 Cara de roce fija / Grain stationnaire / Stationary face / Stationäre Gleitfläche

3 Fuelle / Soufflet / Bellows / Rollbalg

3a Junta elastomérica / Joints secondaires en élastomère / Rubber parts / Elastomerdichtung

4 Muelle / Ressort / Spring / Feder

5 Anillo / Anneau / Ring

5a Anillo / Anneau / Ring

Existen otras combinaciones de materiales

Il existe d'autres combinaisons de matériaux

Available in other materials

Es gibt andere Materialkombinationen